

“From Material to Structure”
MECHANICAL BEHAVIOUR AND FAILURES
OF THE TIMBER STRUCTURES

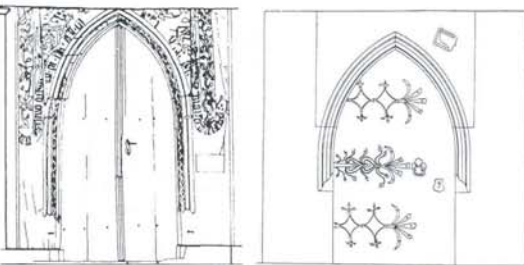

MATERIAL, STRUCTURE AND FORMS OF THE POLISH WOODEN CHURCHES: DUBNE, OBIDOWA, PAWLOWICE(FROM LEFT TO RIGHT)



ABSTRACT
 IN POLAND, THERE ARE STILL ABOUT 4000 HISTORICAL TIMBER OBJECTS INCLUDING ABOUT 900 CHURCHES. THIS COLLECTION SEEMS AN IMPORTANT ELEMENT OF EUROPEAN CULTURAL HERITAGE. IN GENERAL, WOODEN CHURCHES POSSESSING USER AND OWNER REMAIN IN THE BEST TECHNICAL STATE. ONLY ABOUT 80 OF THEM ARE ENDANGERED WITH LOSS. PRESENTED IN THE PAPER ARE OBJECTS MOST CHARACTERISTIC FOR POLISH TIMBER STRUCTURES, WHILE ANALYZING THEIR FORM, STRUCTURE AS WELL AS HISTORICAL AND ARTISTIC VALUES. ALSO DESCRIBED IS THE METHODOLOGY OF CONSERVATION PROCESS, PRESENTING CONSERVATION AND REINFORCEMENT TECHNIQUES OF STRUCTURES ACCEPTABLE FROM THE POINT OF VIEW OF CONSERVATION DOCTRINE.

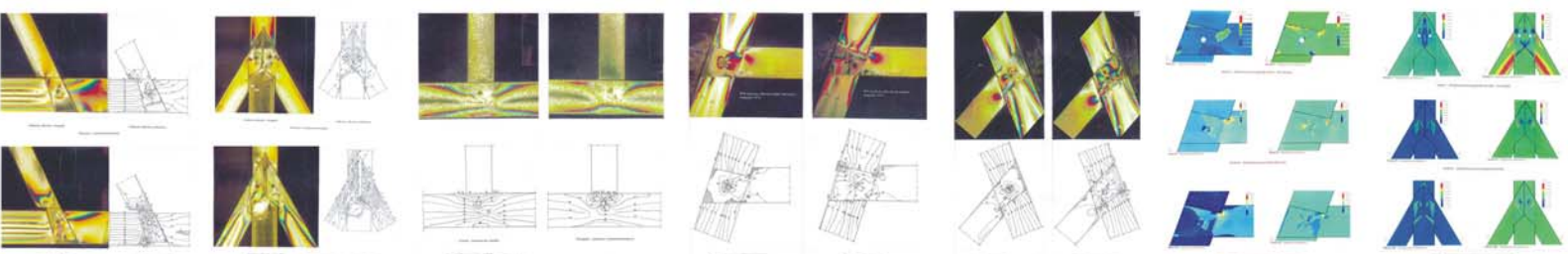
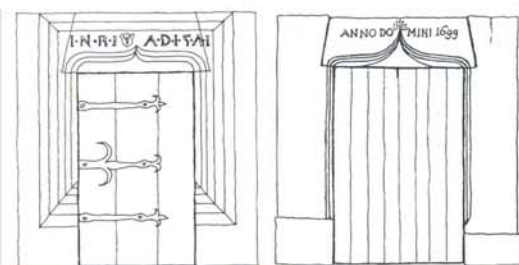

PHOTO-ELASTICITY TEST RESULT (ABOVE) AND STRENGTHENING USING MECHANICAL JOINTS (BELOW)



JERZY JASIEŃKO*, ANDRZEJ KADLUCZKA**, KAZIMIERZ KUSNIERZ***

“POLISH WOODEN ARCHITECTURE - JOINT EUROPEAN HERITAGE”

* PROF., WROCLAW UNIVERSITY OF TECHNOLOGY, POLAND
 **PROF., CRACOW UNIVERSITY OF TECHNOLOGY, POLAND
 ***PROF., CRACOW UNIVERSITY OF TECHNOLOGY, POLAND